



**Technical Specifications:**

Wattage:	100W, 150W, 200W
Power Frequency:	50 / 60Hz
CRI:	>80
Beam Angle:	100W: 120degree 150W: 120degree 200W: 90degree
IP Rating:	65
Impact Rating:	IK10
Luminaire Net Weight:	100W: 6.1kg, 150W: 6.4kg, 200W: 7.2kg
Lumens:	100W: 12,000lm (+/- 5%) 150W: 18,000lm (+/- 5%) 200W: 24,000lm (+/- 5%)
Light Colour:	5000K
Dimming:	1-10V Dimmable
Chips:	Seoul
Driver:	Sosen
Body:	Aluminium Alloy
System Efficacy:	120LM/W [5000K]
Power Factor:	>95
Lifespan:	>50000Hrs [L70@30degrees]
Working Temperature:	-30 - +50degrees
Working Humidity:	15% - 90%RH
Leakage Current:	<0.75mA

NOTE: Not suitable for MARINE applications or in close vicinity to saltwater.

**Accessories:**



50°, 90° and  
120° Lens



120° opaque  
Lens



Adjustable  
Mounting  
Bracket



Daylight  
Harvesting  
Sensor

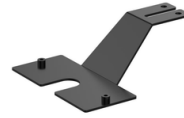

Daylight Harvesting  
Sensor Bracket



Polycarbonate  
Reflector



Aluminum  
Reflector

**Dimensions:**

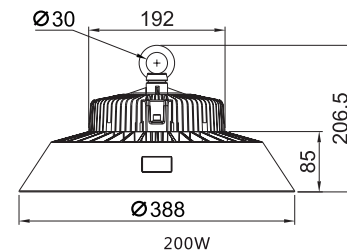
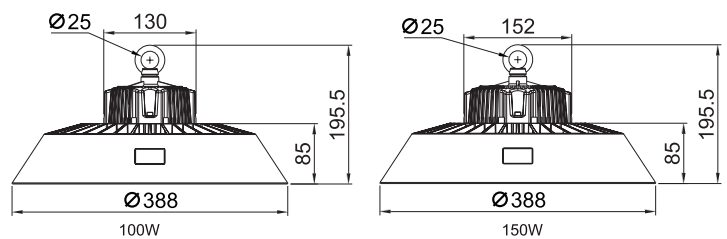

**Illuminance Charts:**

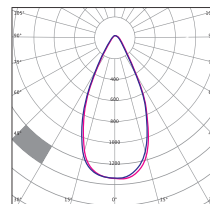

50 Degree Lens

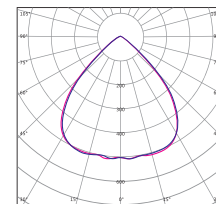

90 Degree Lens

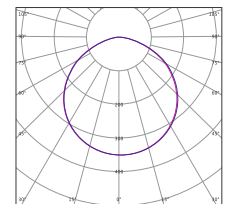

120 Degree Lens

**Compliance:**

AS/NZS 60598

